

Aug. 17, 2018 - 11:16am
 P:\17101.000 (Hot Dog Beach Ocean Facility)\Vault\Design Files\Contract Drawings\17101.000_DFF_GDF_General Plan_0.dwg

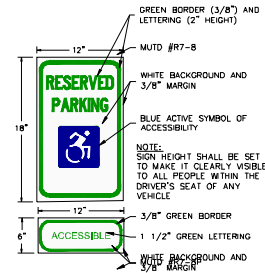

SIGNAGE FOR ACCESSIBLE PARKING
(ACTIVE ACCESS SYMBOL)
N.T.S.

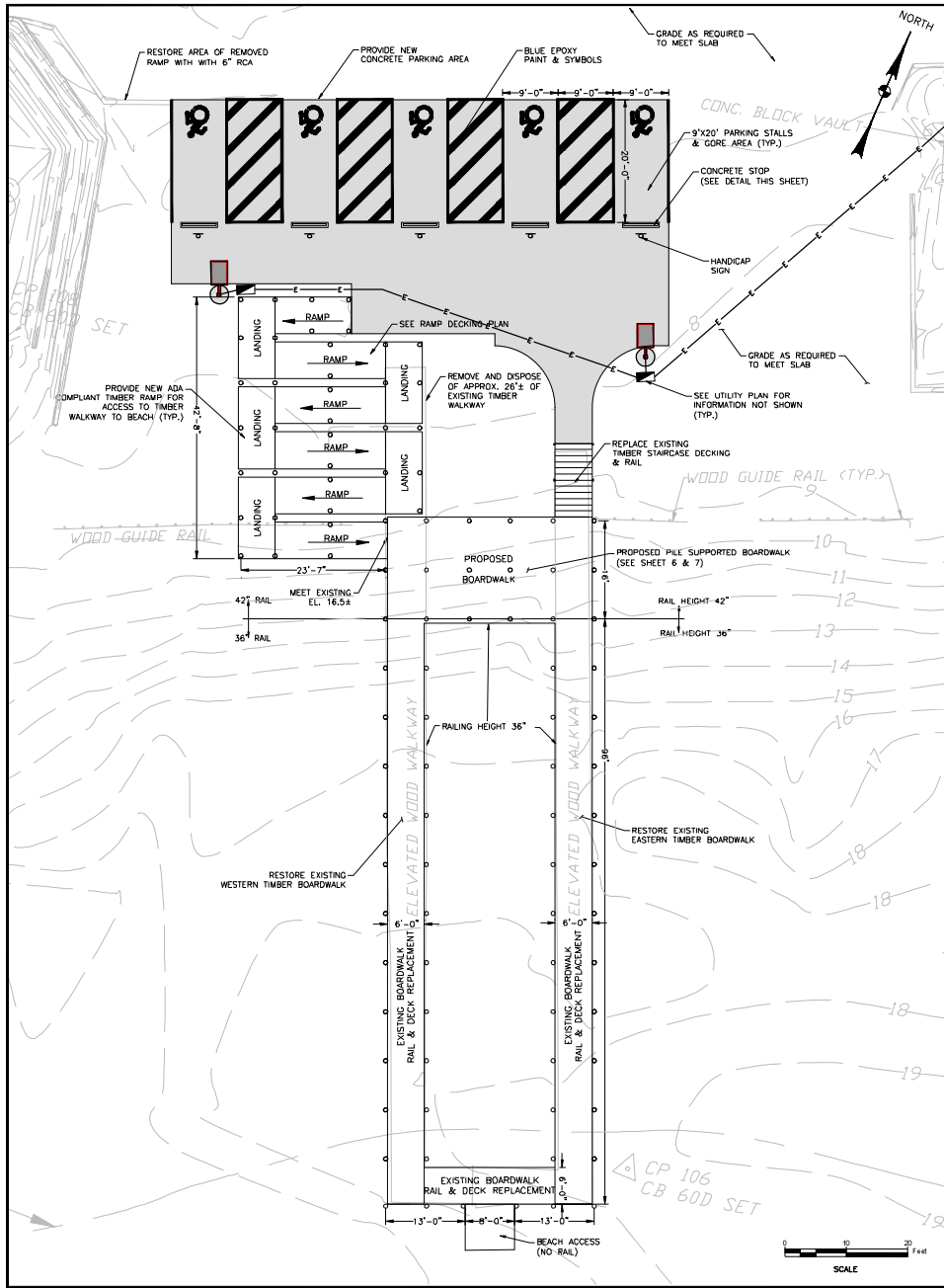
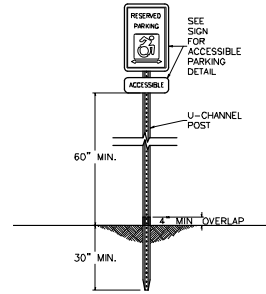

SIGNAGE FOR ACCESSIBLE PARKING
N.T.S.

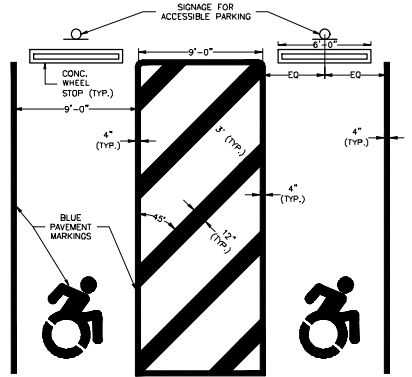

TYPICAL ACCESSIBLE PARKING DETAIL
N.T.S.

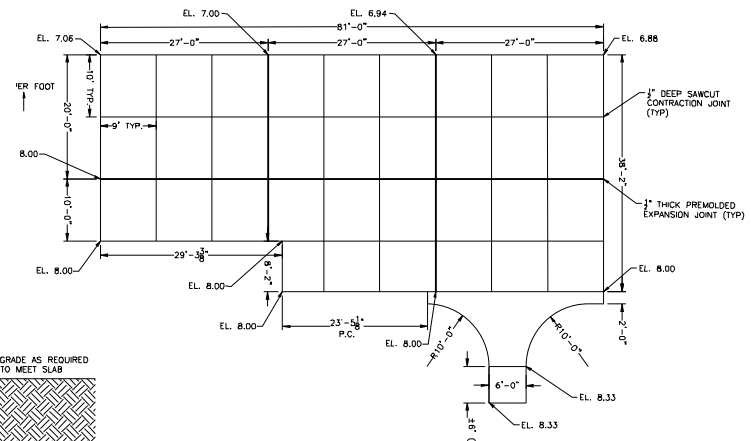

CONCRETE PAVEMENT PLAN
1"=10'

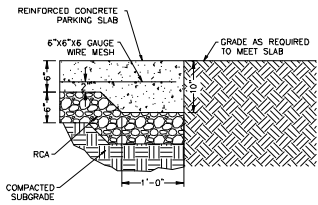

H.C. PARKING SLAB EDGE DETAIL
N.T.S.

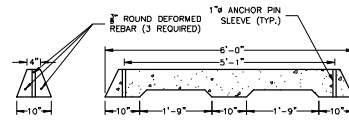

CONCRETE WHEEL STOP DETAIL
N.T.S.

8/23/2018	MCJ	ISSUED FOR BID	RAS
DATE	BY	DESCRIPTION	APPROV. BY
REVISIONS			
TOWN OF SOUTHAMPTON SOUTHAMPTON, NEW YORK HOT DOG OCEAN FACILITY REHABILITATION			
GENERAL PLAN			
L. K. McLEAN ASSOCIATES, P.C. CONSULTING ENGINEERS 437 SOUTH COUNTRY RD., BROOKHAVEN, NY 11718			
Designed By:	MCJ	Scale:	AS SHOWN
Drawn By:	JPR	Date:	AUGUST 2018
Approved By:	RAS	File No.:	17101.000
			5